

Tubular Lever Set



Model:

G 6510

G 6511

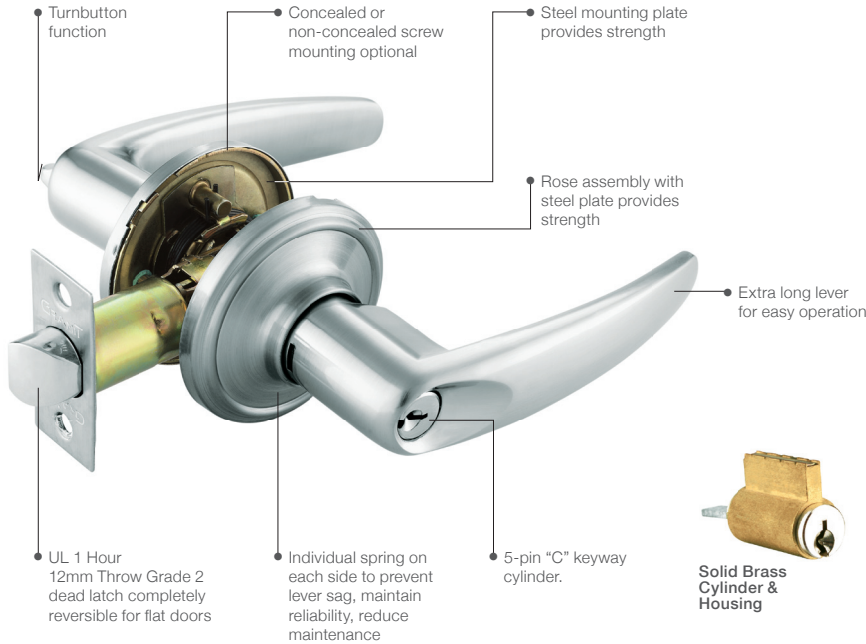

Finishing

- M5** - Antique Brass
- M11** - Antique Copper
- M26D** - Satin Chrome
- PVD** - Physical Vapor Deposition

- Standard adjustable backset 60/70mm

Function

G 6511 / G 6611

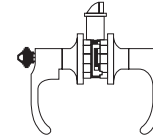

Entrance/Office Lock

Both levers locked or unlocked by key outside or Turnbutton inside.

G 6512 / G 6612

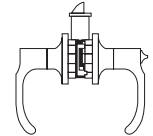

Privacy Lock

Both levers locked or unlocked by Turnbutton inside or emergency key outside.

G 6513 / G 6613

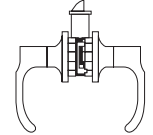

Passage/Hall/Closet

Both levers always free.

Diagram

G 6511

G 6611

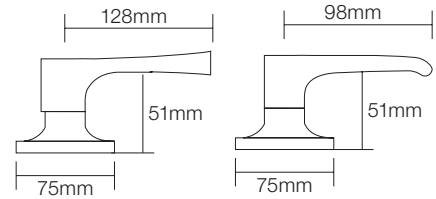

Model:

G 6610

G 6611

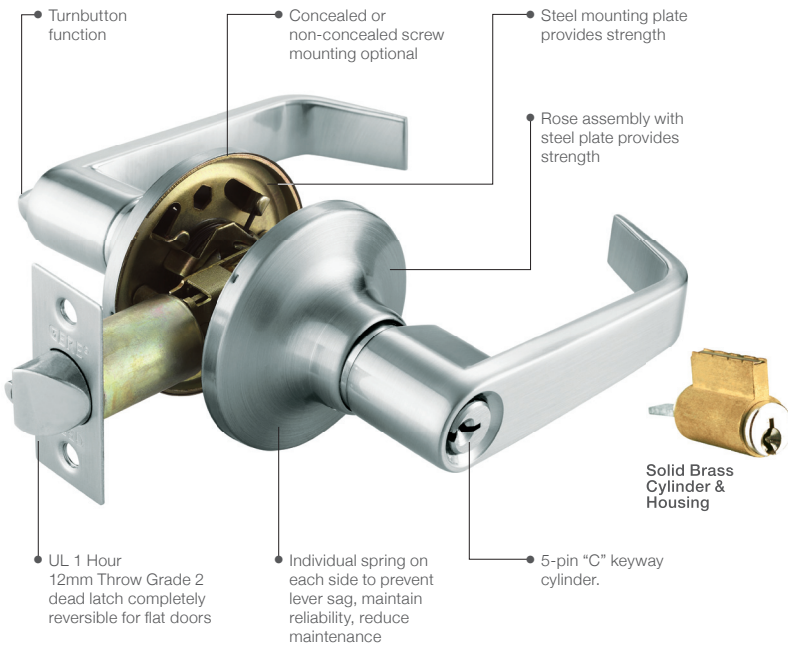

Stock Code	Packing	Weight
G 6511	24 pcs	20 kgs
G 6512	24 pcs	18 kgs
G 6513	24 pcs	17 kgs
G 6611	24 pcs	17 kgs



SIRIM
CERTIFIED TO: ANSI/BHMA A 156.2:2003
Certification No: PC000359

Meets underwriter's laboratories criteria.
Specially designed for barrier free application
Certified to ANSI/BHMA A 156.2:2003 Sirim approval, Grade 3.
Exceeds 200,000 cycles. Certification No: PC000359

Packing - Double blister pack