

# Padlock

Model:

## CL 59

Aluminium Padlock



Solomon Gold  
Colour Code: Y

### Specification

- Rekeyable cylinder
- Stainless steel ball locking
- Both side Shackle locking system
- New padlock can be duplicated from a sample key
- Additional cylinder and padlock can be supplied keyed to this lock
- Precision pin tumble cylinder
- Can be keyed alike key to many security keyways
- Ultra light, colour anodized aluminium padlock body
- 'Snap Shut' function
- This lock converts key retaining to non-key retaining or vice versa easily

### Diagram

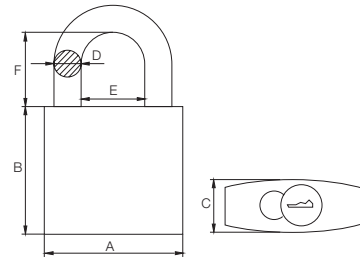

Size	mm	A	B	C	D	E	F
50mm		50	50	20	10	23	30

### 7 Colours

Anodized aluminium padlock body available

**Gorgeous Green**  
Colour Code: G



**Celtic Gray**  
Colour Code: SS



**Royale Blue**  
Colour Code: B



**Black Molly**  
Colour Code: BLK



**Shocking Red**  
Colour Code: R



**Princely Purple**  
Colour Code: P



Stock Code	Size	Packing	Weight
CL59AL50	50 mm	48 pcs	16 kg

Model:

## CL 61

Armoured Spring Loaded Padlock



### Specification

- Hardened steel shackle
- Solid brass body
- 4 Brass keys
- Guarded shackle
- 'Snap Shut' function
- Double blister pack

### Diagram

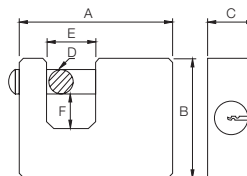

Size	mm	A	B	C	D	E	F
50mm		50	38	15	7.8	14	11
60mm		60	42	16	9	20	12
70mm		70	47	18	10	23	13.5
80mm		80	52	18	11	28	15.5

Stock Code	Size	Packing	Weight
CL 6150	50 mm	48 pcs	11 kgs
CL 6160	60 mm	48 pcs	16 kgs
CL 6170	70 mm	48 pcs	19 kgs
CL 6180	80 mm	48 pcs	23 kgs

