

# Padlock

Model:

**Propilot**

Chromed Steel Padlock

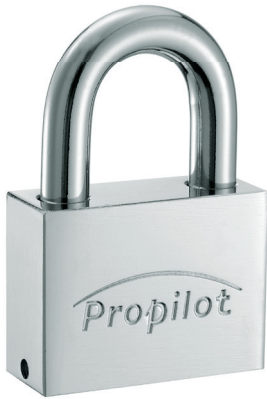

## Specification

- Hardened steel shackle
- Solid chromed steel body
- Zamak 3 Zinc-Alloy-Cylinder
- 4 Chromed steel keys
- Key-Retaining function
- Keyed-Alike up to 1000 pcs/sets is available upon request
- Double blister pack for single padlock
- Skin packed for Keyed-Alike set & master set

## Diagram

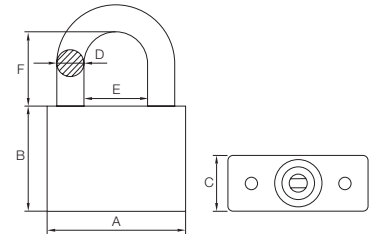

Size	mm	A	B	C	D	E	F
40mm		40	32	20	7.4/7.2	20/19.8	22
50mm		50	38	20	10/9.8	23/23.2	29



Stock Code	Size	Packing	Weight
PCL 401	40 mm	48 pcs	14 kgs
PCL 501	50 mm	48 pcs	19 kgs

Model:

**EUROPLUS**

Chromed Steel Padlock



## Specification

- Hardened steel shackle
- Solid chromed steel body
- Zamak 3 Zinc-Alloy-Cylinder
- 4 Chromed steel keys
- Key-Retaining function
- Keyed-Alike up to 1000 pcs/sets is available upon request
- Double blister pack for single padlock
- Skin packed for Keyed-Alike set & master set

## Diagram

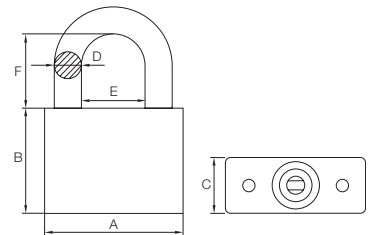

Size	mm	A	B	C	D	E	F
40mm		40	32	20	7.4/7.2	20/19.8	22
50mm		50	38	20	10/9.8	23/23.2	29



Stock Code	Size	Packing	Weight
ECL 401	40 mm	48 pcs	14 kgs
ECL 501	50 mm	48 pcs	19 kgs