

# Padlock

Model:

## CL 98

Anti cut Padlock



### Specification

- Alloy steel shackle
- Anti cut
- Solid satin chromed brass body
- 4 Brass keys
- Brass cylinder
- Brass disc
- Anti-Allenkey bend
- Stainless steel ball bearing
- Key-Retaining function and rekeyable
- Keyed-Alike set of 2 pcs/sets up to 6 pcs/sets is standard
- Masterkey set of 2 pcs/sets up to 5 pcs/sets is standard
- Make to order up to 1000 pcs/sets is also available
- Keyed Alike and Master key is available
- Double blister pack for single padlock
- Skin packed for Keyed-Alike set & Master set

### Diagram

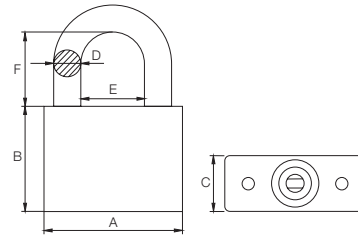

Size	mm	A	B	C	D	E	F
40mm		40	32	20	7.4	20	22
50mm		50	38	20	10	23	27
55mm		55	40	20	11	25	28
60mm		60	42	20	11	27	28



SIRM  
CERTIFIED TO: BS EN 12320:2012 Grade 3  
Certification No: PC000683

Exceeds  
10,000 cycles

Stock Code	Size	Packing	Weight
CL 9840	40 mm	48 pcs	15 kgs
CL 9850	50 mm	48 pcs	20 kgs
CL 9855	55 mm	48 pcs	23 kgs
CL 9860	60 mm	48 pcs	25 kgs

Model:

## CL 90

Heavy duty Oval Padlock



Threaded Bolt End Cap

### Specification

- Alloy Steel Shackle
- Anti-cut
- Chrome brass body
- 4 Brass keys
- Brass Cylinder
- Stainless steel disc
- Threaded bolt end cap
- Stainless steel bearing
- Key-Retaining function and rekeyable
- Keyed alike / Master key available
- Double blister pack

### Diagram

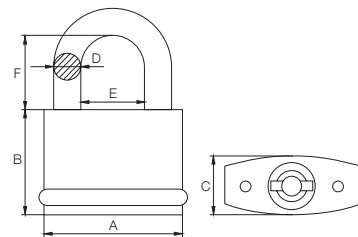

Size	mm	A	B	C	D	E	F
50mm		50	39	22	10	23	29



SIRM  
CERTIFIED TO: BS EN 12320:2012 Grade 4  
Certification No: PC000683

Exceeds  
10,000 cycles

Stock Code	Size	Packing	Weight
CL 9050	50 mm	48 pcs	22 kgs